

Part Number System for Pan-Term® Terminals

P	N	14	—	4	R	X	—	C
Type	Insulation	Wire Range		Stud Size	Tongue Configuration	Special Configuration		Std. Pkg. Size
P = Seamed Barrel	H = Heat Shrink	22 = #26 – 22		2 = #2	HDR = Heavy Duty Ring	HT6 = High Temperature		5 = 5
S = Seamless Tubular Barrel	K = KYNAR ■	18 = #22 – 18		4 = #4	F = Fork	N = Narrow Tongue		X = 10
	Insulated	14 = #16 – 14		5 = #5	FF = Flanged Fork	W = Wide Tongue		E = 20
	N = Nylon Insulated	12 = #16 – 12		6 = #6	LF = Locking Fork	X = Expanded Insulation		Q = 25
	NF = Nylon Insulated Funnel Entry	10 = #12 – 10		8 = #8	R = Ring	= Non-Expanded Insulation (leave blank)		L = 50
	V = Vinyl Insulated	8 = #8		10 = #10				C = 100
	= Non-Ins. (leave blank)	6 = #6		14 = 1/4"				T = 200
		4 = #4		56 = 5/16"				D = 500
		2 = #2		38 = 3/8"				M = 1000
		1 = #1		76 = 7/16"				
		1/0 = 1/0		12 = 1/2"				
		2/0 = 2/0						
		3/0 = 3/0						
		4/0 = 4/0						
		250 = 250kcmil						

■ KYNAR is a registered trademark of Atofina Chemicals, Inc.



Ring Terminal, Non-Insulated – High Temperature

Type P-RHT

- Ring tongue design assures a secure connection in high vibration applications
- Nickel plated copper for temperatures up to 650°F (343°C)
- Internal barrel serrations assure good wire contact and maximum tensile strength
- Brazed seam protects terminal barrel from splitting during the crimp process
- Barrel of terminal internally beveled to provide quick and easy wire insertion
- Rated up to 2000 V



Part Number	Wire Range	Stock Thickness (In.)	Stud Size	Figure Dimensions (In.)			Recommended Installation Tool	Std. Pkg. Qty.**	Std. Ctn. Qty.
				L	W	C			
P18-6RHT6-C	22 – 16 AWG	0.03	#6	0.62	0.25	0.21	CT-100A, CT-200, CT-600-A, CT-1570, CT-2500	100	1000
P18-8RHT6-C		0.03	#8	0.71	0.31	0.25		100	1000
P18-10RHT6-C		0.03	#10	0.71	0.31	0.25		100	1000
P14-6RHT6-C	18 – 14 AWG	0.03	#6	0.62	0.25	0.20	CT-100A, CT-200, CT-600-A, CT-1570, CT-2500	100	1000
P14-8RHT6-C		0.03	#8	0.71	0.31	0.25		100	1000
P14-10RHT6-C		0.03	#10	0.71	0.31	0.25		100	1000
P10-6RHT6-L	12 – 10 AWG	0.04	#6	0.78	0.31	0.35	CT-100A, CT-200, CT-600-A, CT-1570, CT-1701, CT-2500	50	500
P10-8RHT6-L		0.04	#8	0.78	0.31	0.35		50	500
P10-10RHT6-L		0.04	#10	0.81	0.38	0.33		50	500
P10-14RHT6-L		0.04	1/4"	0.96	0.53	0.42		50	500

Large Wire, Non-Insulated – High Temperature

P8-8RHT6-Q	8 AWG	0.04	#8	1.12	0.42	0.43	CT-2600, CD-2600-P8	25	250
P8-8RHT6-Q		0.04	#8	1.09	0.36	0.43		25	250
P8-10RHT6-Q		0.04	#10	1.14	0.42	0.43		25	250
P8-10RHT6-Q		0.04	#10	1.09	0.36	0.43		25	250
P8-14RHT6-Q		0.04	1/4"	1.14	0.47	0.43		25	250
P8-56RHT6-Q		0.04	5/16"	1.25	0.59	0.51		25	250
P8-38RHT6-Q		0.04	3/8"	1.25	0.59	0.51		25	250
P8-12RHT6-Q		0.04	1/2"	1.36	0.82	0.54		25	250
P6-8RHT6-E	6 AWG	0.05	#8	1.21	0.47	0.43	CT-2600, CD-2600-P6	20	200
P6-10RHT6-E		0.05	#10	1.21	0.47	0.43		20	200
P6-14RHT6-E		0.05	1/4"	1.21	0.47	0.43		20	200
P6-56RHT6-E		0.05	5/16"	1.33	0.62	0.51		20	200
P6-38RHT6-E		0.05	3/8"	1.33	0.62	0.51		20	200
P6-12RHT6-E		0.05	1/2"	1.43	0.82	0.51		20	200
P4-10RHT6-E	4 AWG	0.05	#10	1.40	0.55	0.50	CT-2600, CD-2600-P4	20	200
P4-14RHT6-E		0.05	1/4"	1.40	0.55	0.50		20	200
P4-56RHT6-E		0.05	5/16"	1.46	0.68	0.50		20	200
P4-38RHT6-E		0.05	3/8"	1.46	0.68	0.50		20	200
P4-12RHT6-E		0.05	1/2"	1.55	0.86	0.53		20	200
P2-10RHT6-X	2 AWG	0.06	#10	1.46	0.68	0.58	CT-2600, CD-2600-P2	10	100
P2-14RHT6-X		0.06	1/4"	1.46	0.68	0.58		10	100
P2-56RHT6-X		0.06	5/16"	1.46	0.68	0.58		10	100
P2-38RHT6-X		0.06	3/8"	1.46	0.68	0.58		10	100
P2-12RHT6-X		0.06	1/2"	1.55	0.86	0.58		10	100

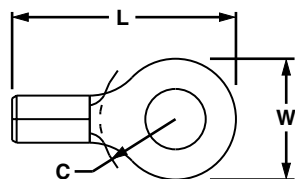

**Bulk packaging may be available, contact Panduit® Customer Service for additional information.